

Lenovo 11e Chromebook & Lenovo 100e Chromebook



For Chromebook assistance please contact district's student helpdesk.

Phone #: (623) 547-1516

Email: studenthelp@lesd.k12.az.us

Lenovo 100e Chromebook

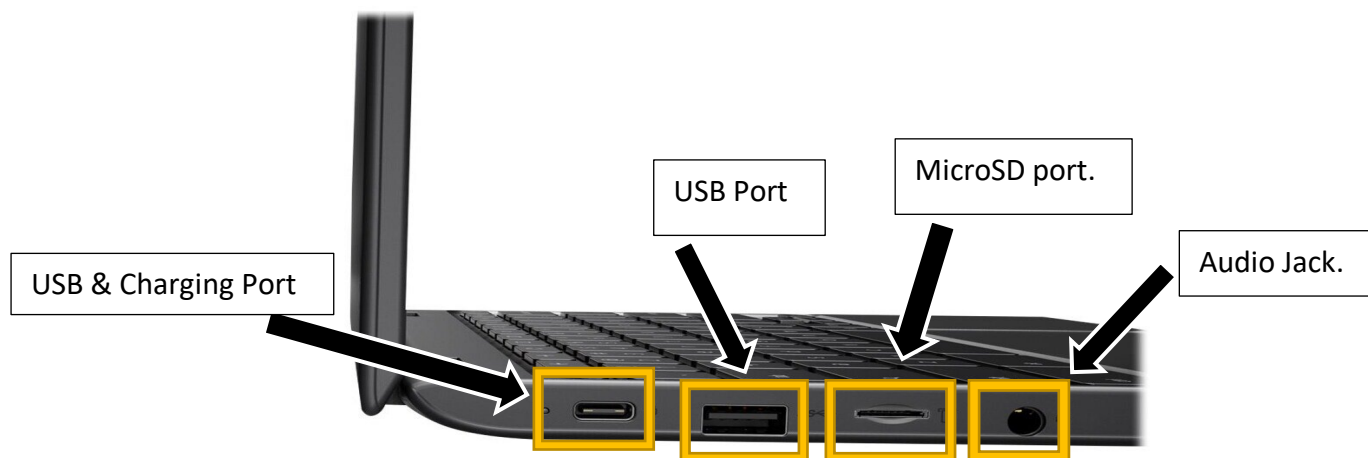
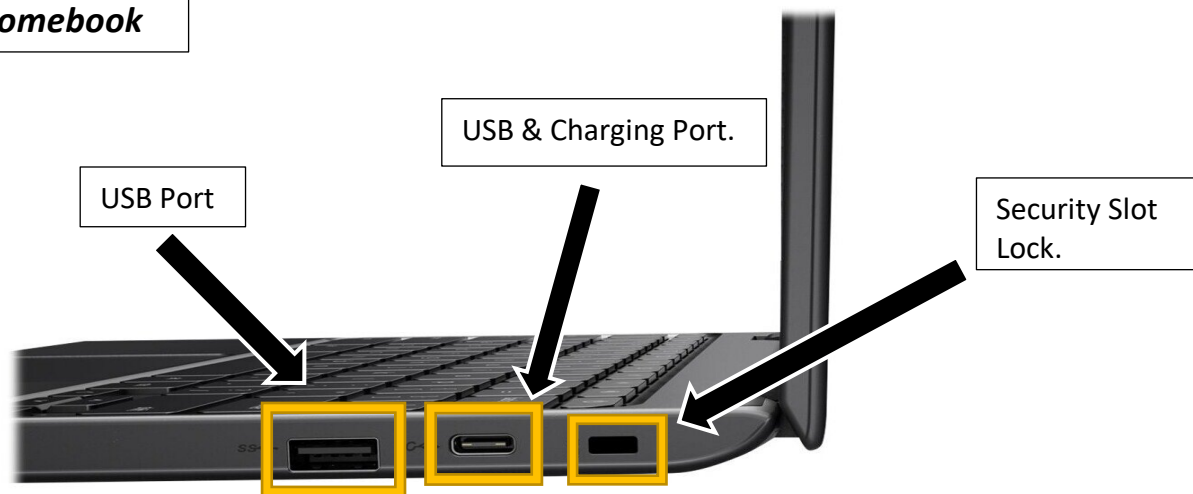

Lenovo 11e Chromebook

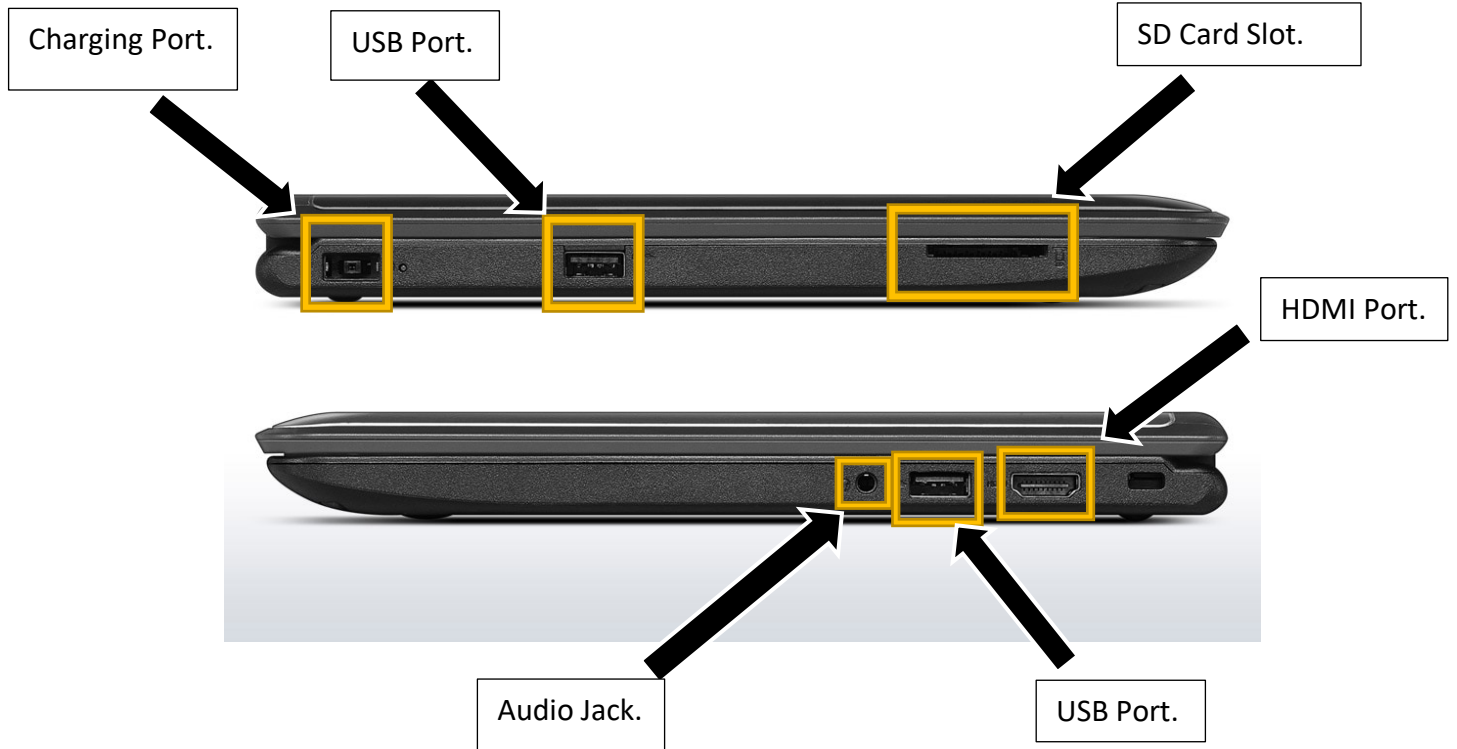

How to connect to home Wi-Fi network and sign in to Chromebook.

1- Select home Wi-Fi network from network list.

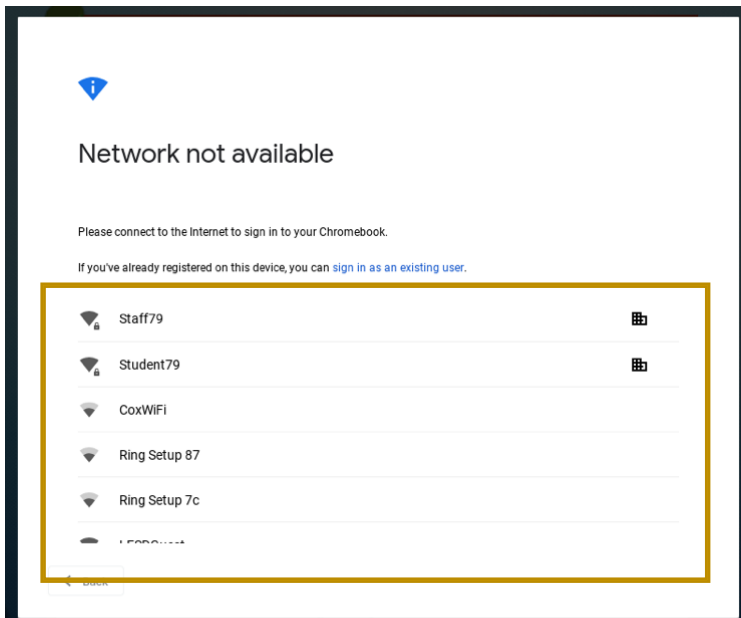

2- Type in home Wi-Fi network password and click "Connect".

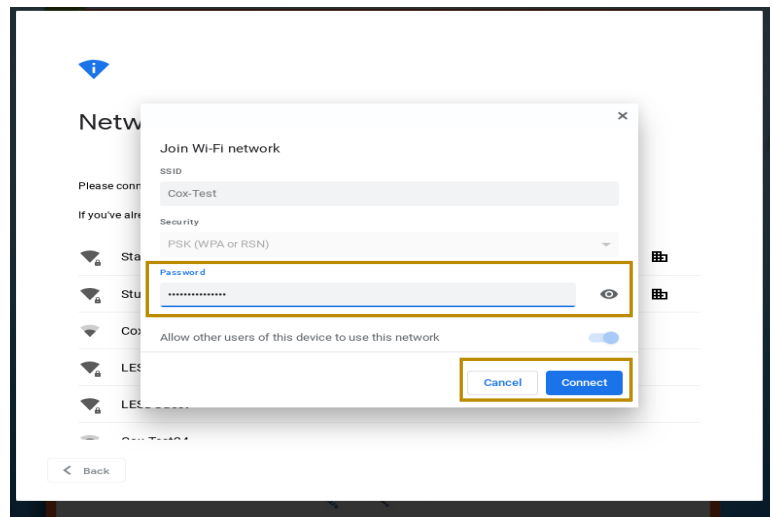

3- Sign in by typing in your school email account and click next.

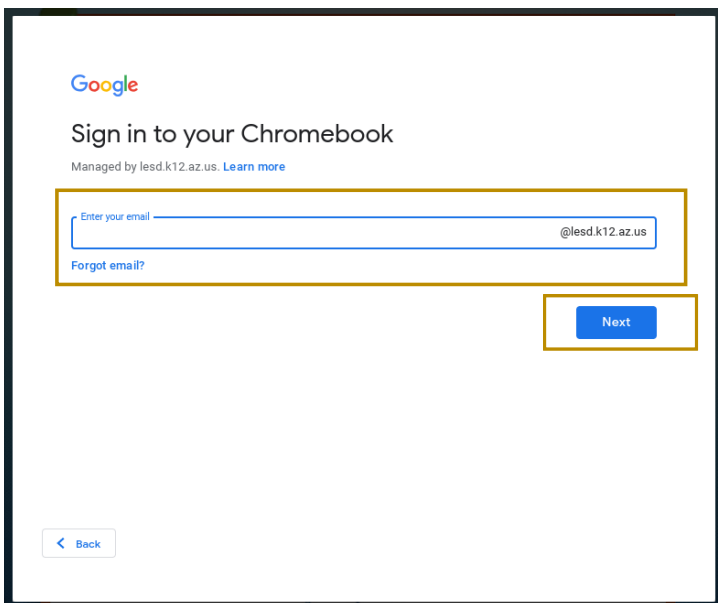

4- Type in your school email account password and click next. You will be signed in.

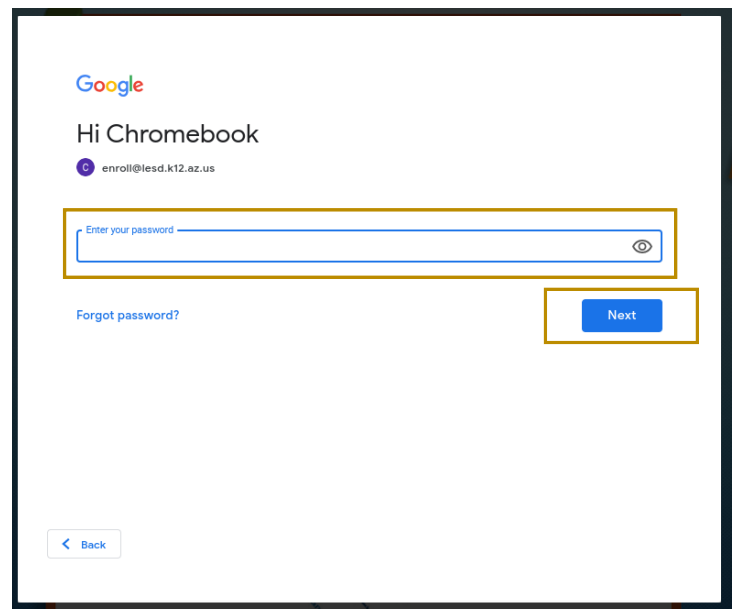

Note: New students might not have email account available until first day of school.

Signing out and shutting down computer.

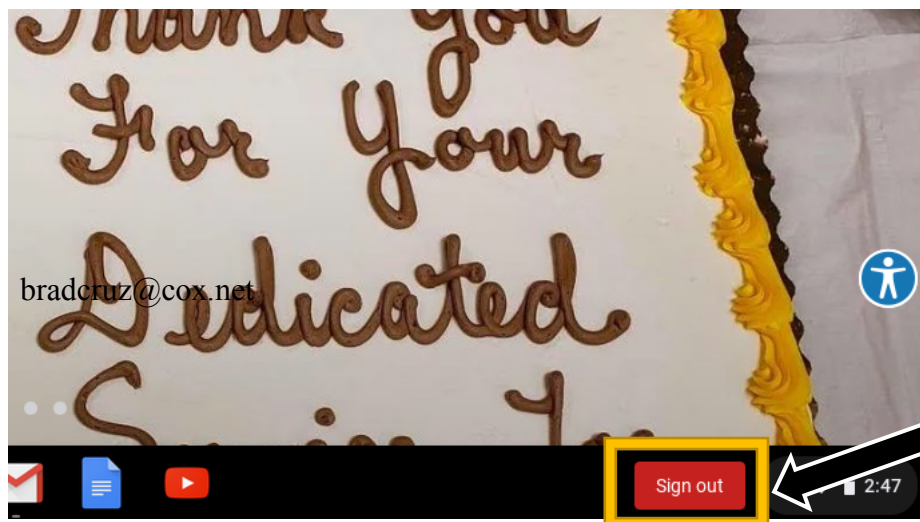

Click to sign out.

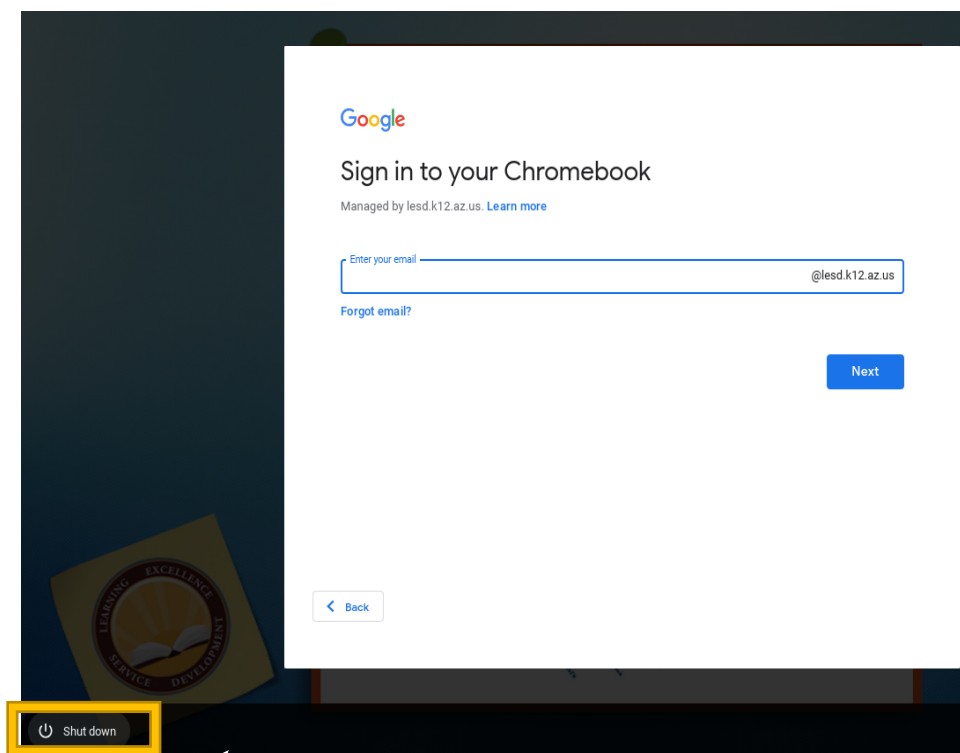

Click to shut down.

For Chromebook assistance please contact district's student helpdesk.

Phone #: (623) 547-1516

Email: studenthelp@lesd.k12.az.us